

Community Profile

Temagami First Nation



Temagami First Nation

www.temagamifirstnation.ca

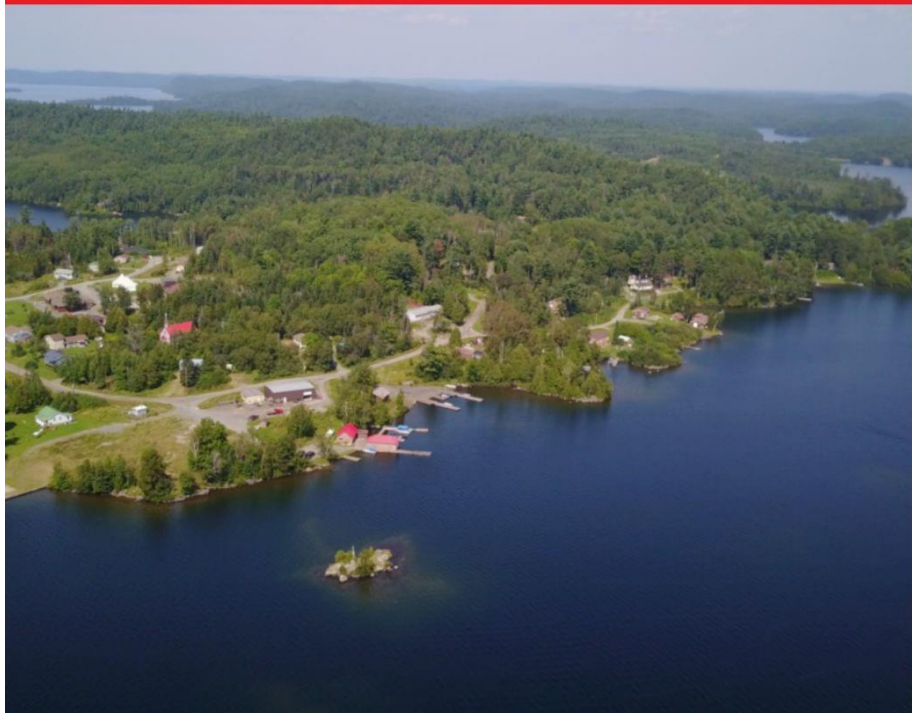

Revised February 2019

Table Of Contents

General Description	3
Geographic Setting	3
Climate	4
Social Setting.....	4
History	4
Administration and Representation	5
Community Services	6
Education and Health Services	6
Recreation Facilities	7
Arts and Culture	7
Housing.....	7
Temagami First Nation Operating Expenses	8
Proximity to Business Markets	9
Employment by Economic Sector	9
Population Characteristics	10
Family and Household Characteristics	11
Education Profile	11
Capital Projects Underway	12
General Contact Information	12

Temagami First Nation Mailing Address:

General Delivery, Bear Island, Lake Temagami, ON, P0H 1C0
Toll Free: 1-888-737-9884 Phone: (705) 237-8943 Fax: (705) 237-8959

General Description

Bear Island, with a non seasonal population of 244 people, is home to the **Temagami First Nation**. The community is rich in natural environmental beauty and offers many opportunities for recreation and new and expanding businesses. The Temagami First Nation is the Body Politic of over 800 Teme Augama Anishnabai who are presently recognized as Indians under the Indian Act of Canada.

The following information highlights the many services this community has to offer.

Geographic Setting

Latitude: 46°58'27.8782" North

Longitude: 080°04'28.7292" West

Postal Code: P0H 1C0

The Temagami First Nation is located on Bear Island. Bear Island is the second largest of over 1250 islands in Lake Temagami and is situated in the Nipissing District of the North East region of the Province of Ontario. This is one of the most densely populated districts in Northern Ontario. Roughly triangular in shape, Bear Island sits at the geographic centre (hub) of Lake Temagami and has an area of 2.91 square kilometers.



Lake Temagami is a large, deep and irregularly shaped lake with a surface area of 20,853 hectares. Because of its irregular shape and five elongated bays, Lake Temagami has a shoreline of 1046 km (Land Information Ontario: Ontario Hydro Network). Its depth ranges to 107 metres, giving rise to the Anishinaabe name "*Teme Augama*" meaning "*deep water by the shore*". It is the backbone of over 2,000 km of interconnecting canoe routes.

The community is near the Municipality of Temagami. The town and its seasonal residents draw many tourists to the area, with opportunities for cottaging, fishing, hunting, camping, hiking, snowmobiling and canoeing.

The area is part of the Canadian Shield, one of the largest single exposures of Precambrian rocks in the world. The surrounding forest is primarily coniferous, with red and white pine, spruce, jack pine and balsam fir dominating the landscape. Deciduous trees in the region include maple, poplar and birch species. The area forests also boasts remnants of 'old growth' forest. The region has considerable mining and forestry potential and activity.

The major access point to Bear Island is from the western end of the Lake Temagami Access Road, 18 kilometers from an intersection with Highway 11. This intersection is 6.8 km south of the municipality of Temagami.

Bear Island is accessed via boat during spring, summer and fall, and via an ice road during winter months.

Climate



Temagami First Nation lands are located in Canada's Ontario Shield Ecozone. The climate in this ecoregion is humid and cool. It has been classified by the Ecoregions Working Group (1989) as the Humid Low Boreal Ecoclimatic Region.

Mean annual precipitation in the ecoregion ranges between 725 and 1,148 mm per year and the mean summer rainfall is between 217 and 291 mm. The mean annual temperature ranges from 0.8 to 4.3°C and the mean growing season length is 171 to 200 days (Ecoregions Working Group, 1989; Hills, 1959; Mackey et al., 1996a, b).

Weather Averages

	January	February	March	April	May	June	July	August	September	October	November	December
Avg. Temperature (°C)	-14.4	-12.6	-6.5	2.6	10.1	15.5	18.4	16.9	11.9	6.1	-1.5	-10.6
Min. Temperature (°C)	-20.2	-18.5	-12.3	-2.9	3.9	9.5	12.7	11.4	6.8	1.7	-4.9	-15.3
Max. Temperature (°C)	-8.6	-6.6	-0.6	8.2	16.4	21.6	24.2	22.5	17.1	10.6	2	-5.8
Avg. Temperature (°F)	6.1	9.3	20.3	36.7	50.2	59.9	65.1	62.4	53.4	43.0	29.3	12.9
Min. Temperature (°F)	-4.4	-1.3	9.9	26.8	39.0	49.1	54.9	52.5	44.2	35.1	23.2	4.5
Max. Temperature (°F)	16.5	20.1	30.9	46.8	61.5	70.9	75.6	72.5	62.8	51.1	35.6	21.6
Precipitation / Rainfall (mm)	58	49	56	55	71	88	86	91	96	76	71	64

(<https://en.climate-data.org>)

Social Setting

Temagami First Nation prides itself on its rich cultural heritage and the pristine natural beauty of its surroundings.

Residents enjoy many festivities and cultural events throughout the year to acknowledge their culture and lifestyle including a powwow, community festivals, cultural performances and birch bark canoe builds.

Temagami First Nation also offers an excellent primary public school, community health care, a caring social support system and an abundance of recreational activities.

History

N'Daki Menan

The Temagami First Nation is situated at the cultural and historic heart of n'Daki Menan ("Our Homeland".)

The Teme Augama Anishnabai have occupied this area as their traditional territory for thousands of years. At the time of the Royal Proclamation in 1763, through to and beyond the signing of Robinson Treaties in 1850, the People of the Deep Water were a self-governing nation possessing over 10,000 square kilometers of geographically-defined lands.

Each family maintained its own tract of 500 to 750 square kilometres. Just before European contact, our history documents that our 14 families who inhabited n'Daki Menan were relatively sedentary, forming a society specific to this area.

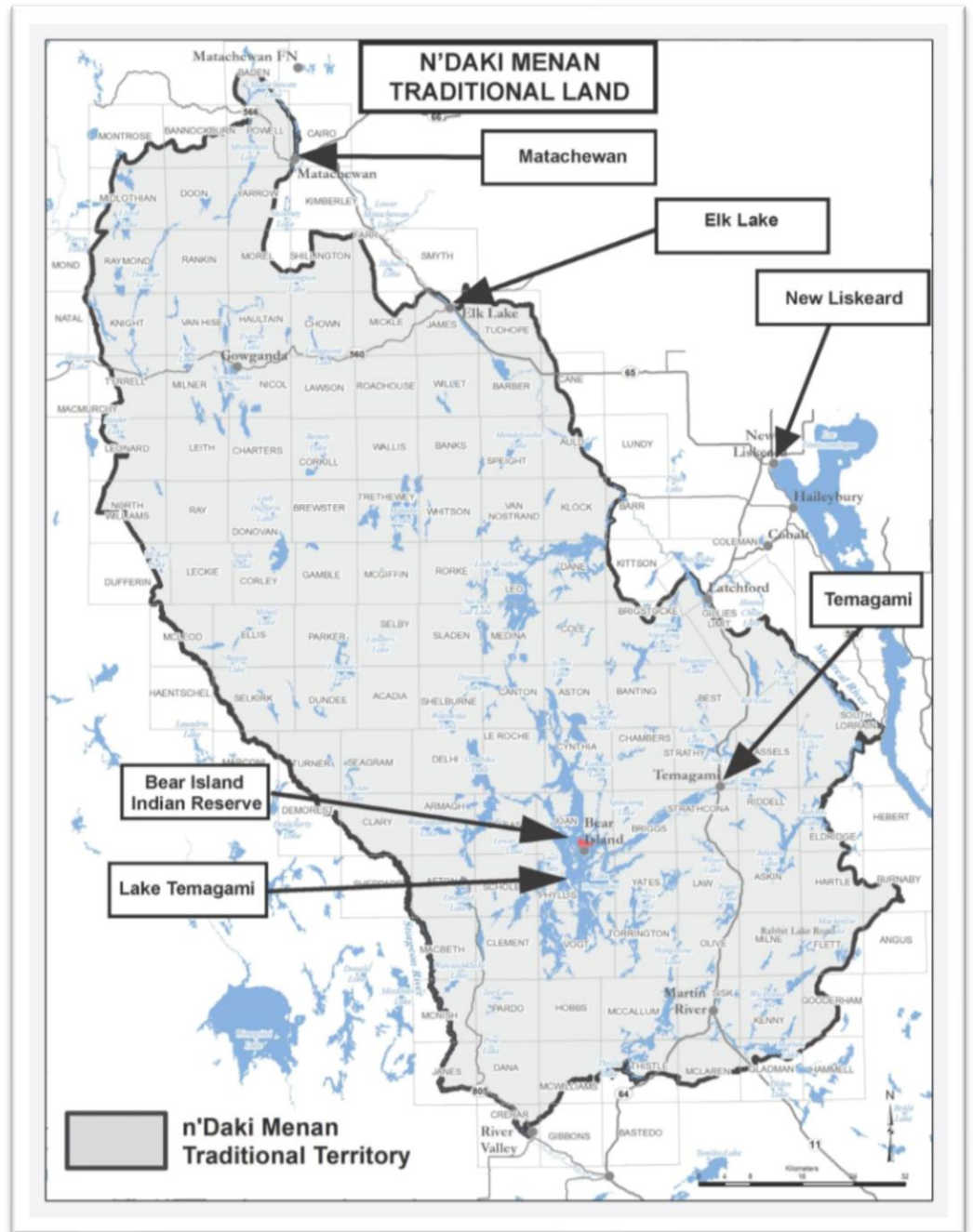

Community Services

The **Temagami First Nation Public Library** and the **Bear Island Police Service** are housed out of the same building. The library provides a number of books and literacy resources, as well as providing public computer and internet services. The police service provides two Bear Island Police constables.

The **Community Fire Hall and Emergency First Response building** accommodates storage for fire equipment for the Volunteer Fire Department and the volunteer Emergency First Response Team vehicle.

The **Store Complex** is a community owned building that is leased to a privately-owned confectionary business run by a Temagami First Nation community member. It houses a post office.

Community Infrastructure includes the operation and maintenance of roads and the maintenance of Band buildings. The Community is serviced by a **water treatment plant** and a **water distribution system**, as well as an **emergency power supply**. The raw water is collected from Lake Temagami and delivered via a low lift station to the water treatment plant. The community's wastewater collection, treatment and disposal system includes two lagoons. A **Garbage Transfer Station** is located south-east on the island. The Island has three phase electrical power. Ontario Hydro is the service provider for Bear Island electricity.

Communications infrastructure consists of reliable internet connectivity, throughout the Island, with a high rate of residential internet usage. Cellular service is available in some locations on Bear Island; however, there are areas where cellular signal is unpredictable.

Temagami First Nation Emergency Services operates a boat shuttle service and possesses an airboat that can be utilized for emergency services during ice freeze up and break up. There is a helipad for emergency airlift situations. Bear Island has a volunteer fire department and a fire hydrant network in place.

Educational and Health Services

The **Laura McKenzie Learning Centre** is the Temagami First Nation band run elementary school (grades K-8). Although secondary and post-secondary school students attend their studies off-reserve, programming for these students are administered by the Education Manager housed in this building.

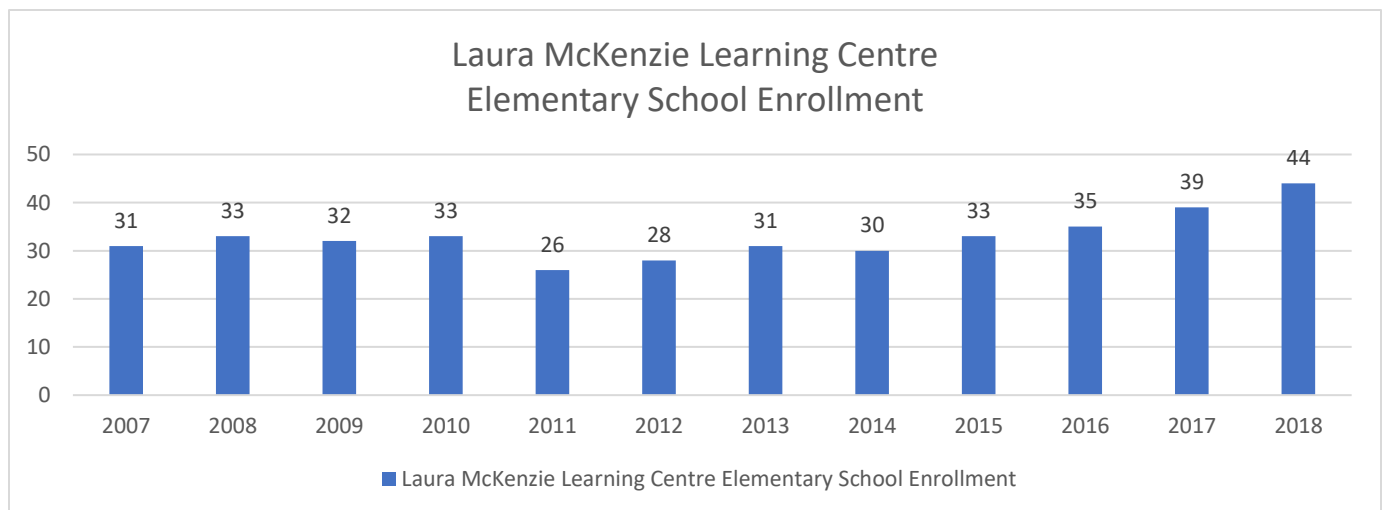

The **Doreen Potts Health Centre** is Temagami First Nation's central health building providing health related services. This building houses a Health Services Manager, a Community Health Nurse, a Community Health Representative, the Health Promotion Program and the Home and Community Care Program. Services provided to the community include medical transportation, home support services, nursing and programs designed to enhance the health of community members.

The Family Healing and Wellness Centre houses various social programming for the Temagami First Nation community. Services offered include Native Child Welfare Prevention Program, Healthy Babies Program, Native Drug and Alcohol Prevention Program, Ontario Works, and Community Wellness Program.

The Tillie Missabie Family Centre is the community day care facility and provides daycare programming as well as the Aboriginal Head Start programming. The Aboriginal Head Start Program is designed to prepare our young children for their school, by meeting their emotional, social, health and nutritional needs. This program encourages the development of activities such as culture and language.

Recreation Facilities

The Sonny Moore Building is a recreational building that is often used to prepare for baseball, pow wow and winter skating activities. An outdoor skating rink and baseball diamond are located directly beside this building.

The Elders Recreational Building (also known as the **Northstar Building**) is a community building accommodating elders' recreational activities.

Arts & Culture

The Canoe House is a community space conceived for passing on traditions and Indigenous knowledge. The goal of the Canoe House is to have diverse cultural activities made available for residents as well as the many cottagers and visiting campers, boaters, and paddlers on the lake.

There is a Roman Catholic church located in the community. **The Church of St. Ursula** is considered to be of historic significance to the community.



Housing

Bear Island supports 110 Housing units, 104 with Electrification, 102 with Solid Waste Service, where solid waste is disposed to a community facility that is consistent with provincial/territorial regulations, and 108 with Road Access. 74 units have community system water delivery and 36 units have their own individual system. (Community Infrastructure and Housing Annual Report 2017.)

66 percent of on reserve housing units are owned by the inhabitants, 17 percent are rented and 16 percent are band owned (2016 Census Profile for Temagami First Nation.)

Temagami First Nation employs a Housing Coordinator who is responsible for rental units, Canada Mortgage and Housing Corporation rent to own housing and Residential Repair Assistance Programs.



Temagami First Nation Operating Expenses

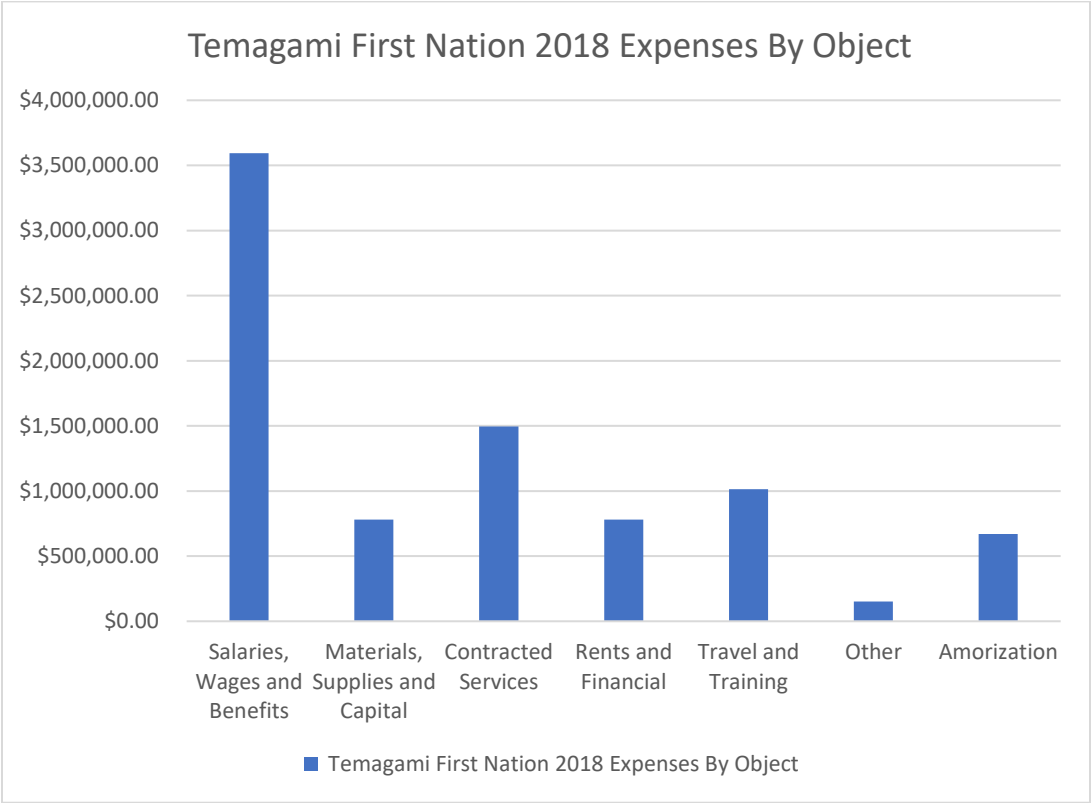
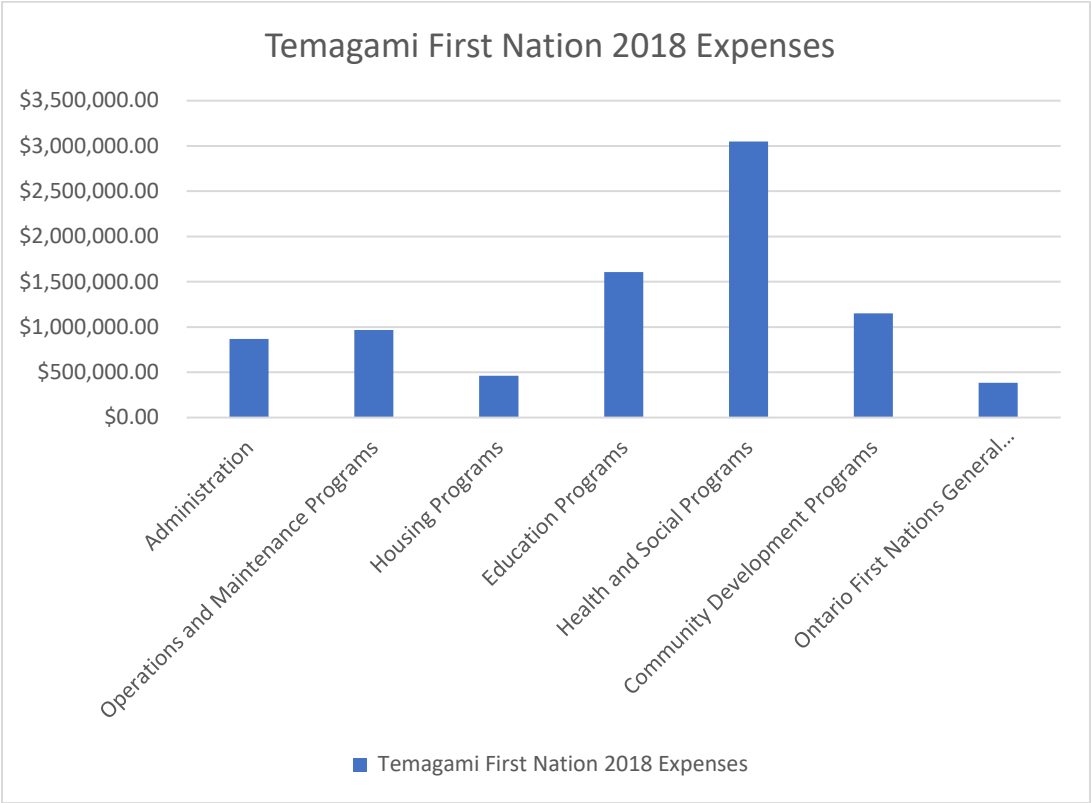

Proximity to Business Markets

Market	Highway Distance	Market Population
Temagami	29 km	802 (2016 Census data)
Temiskaming Shores	85 km	9,920 (2016 Census data)
North Bay	90 km	51,553 (2016 Census data)
Sudbury	175 km	165,270 (2018 Census data)
Toronto	440 km	6,346,088 (2018 Census data)
Ottawa	466 km	1,377,016 (2018 Census data)

Employment by Economic Sector

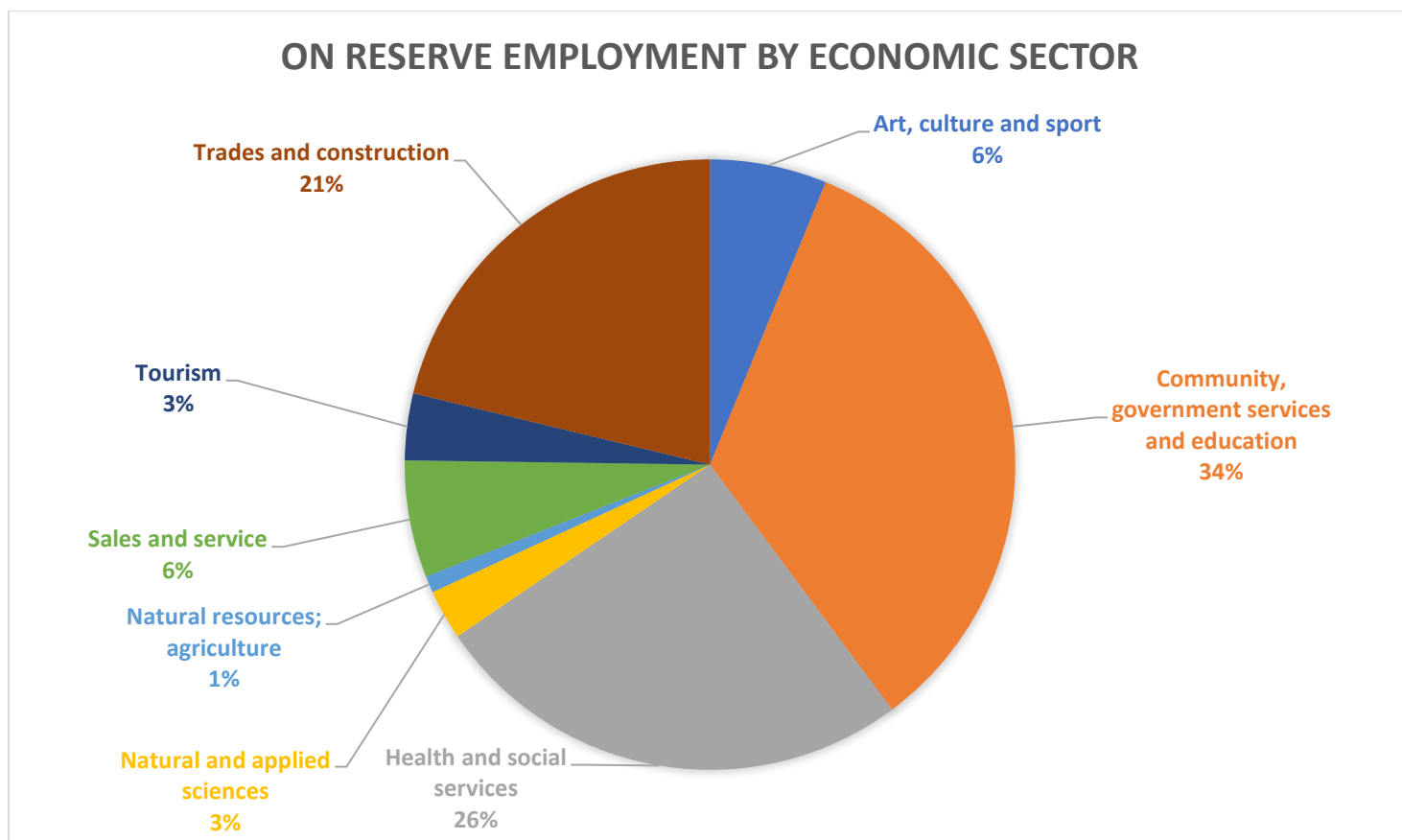

Art, Culture and Sport - 6%

Includes occupations in art and culture, including the performing arts, film and video, broadcasting, journalism, writing, creative design, libraries and museums. It also includes occupations in recreation and sports.

Community, Government Services and Education - 34%

Includes occupations concerned with teaching, educational support, developing government policy, and administering government and other programs.

Health and Social Services - 26%

Includes occupations concerned with providing health care and social services directly to patients and occupations that provide support to medical social service staff.

Natural and Applied Sciences - 3%

Includes occupations in sciences, engineering, architecture and information technology.

Natural Resources; Agriculture - 1%

Includes supervisors and equipment operators in the natural resource-based sectors of mining, oil and gas production, forestry and logging, agriculture, horticulture and fishing.

Sales and Service - 6%

Includes retail and wholesale sales occupations and customer and personal service occupations related to a wide range of industries, such as accommodation and food services, travel, tourism and cleaning services.

Tourism - 3%

Includes occupations that supervise and co-ordinate the activities of hotel accommodations, and travel guides, outdoor sport, hunting, fishing and and recreational guides.

Trades and Construction - 21%

Includes trades supervisors and contractors, construction and mechanical tradespersons, operators of transportation and heavy equipment and trades helpers. This category includes most of the apprenticeable trades, including all those related to the construction industry.

Population Characteristics

Bear Island has a nonseasonal population of 244, comprised of 118 male residents and 126 female residents. In addition, there are 47 seasonal residents, 24 being male and 23 being female. Residents under 25 comprise 34.43 % of the population, with a male to female ratio of 39:45. Residents between 26 and 49 comprise 31.14 % of the population with a male to female ratio of 38:38. Residents over the age of 50 comprise 34.43 % of the population, with a male to female ratio of 41:43. The nonseasonal population density is 84 people per square kilometre and the seasonal population density is 100 people per square kilometre.

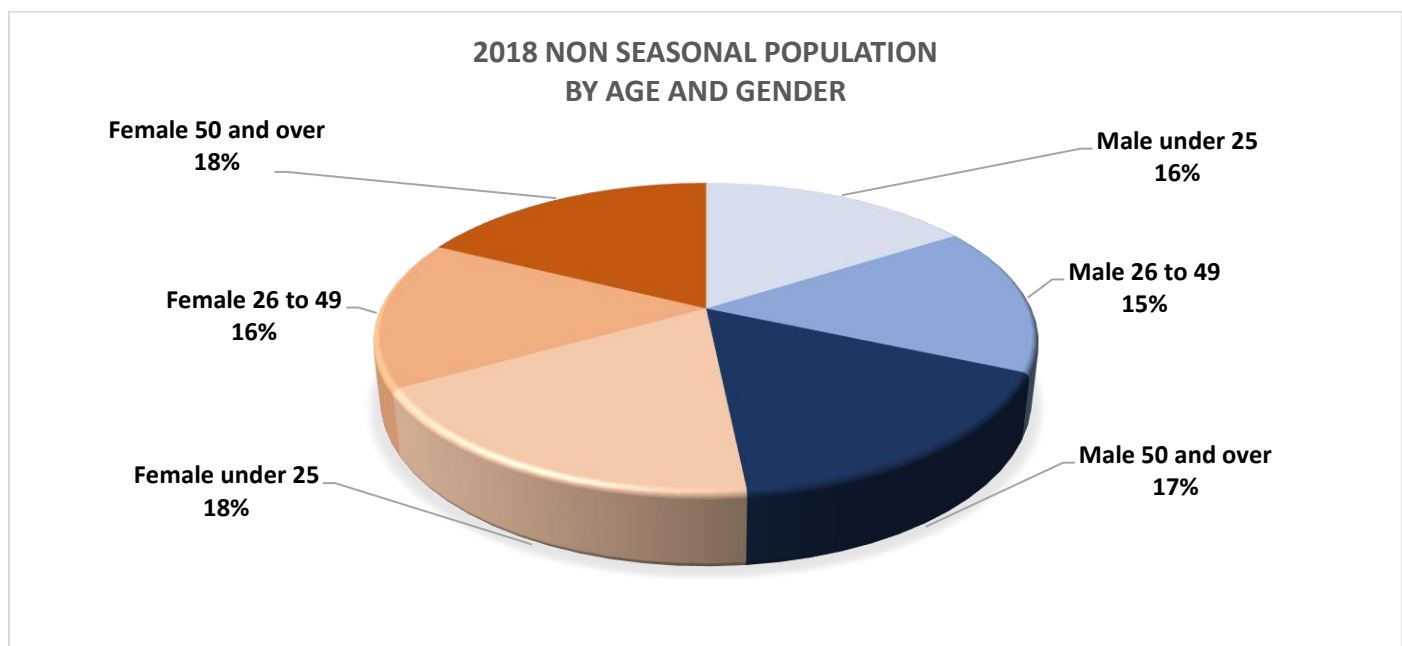

Family and Household Characteristics

The average Family Household on Bear Island has 2.6 people. 67 percent of dwellings are owned by the occupants, while 33 percent of housing is either rented or band owned.

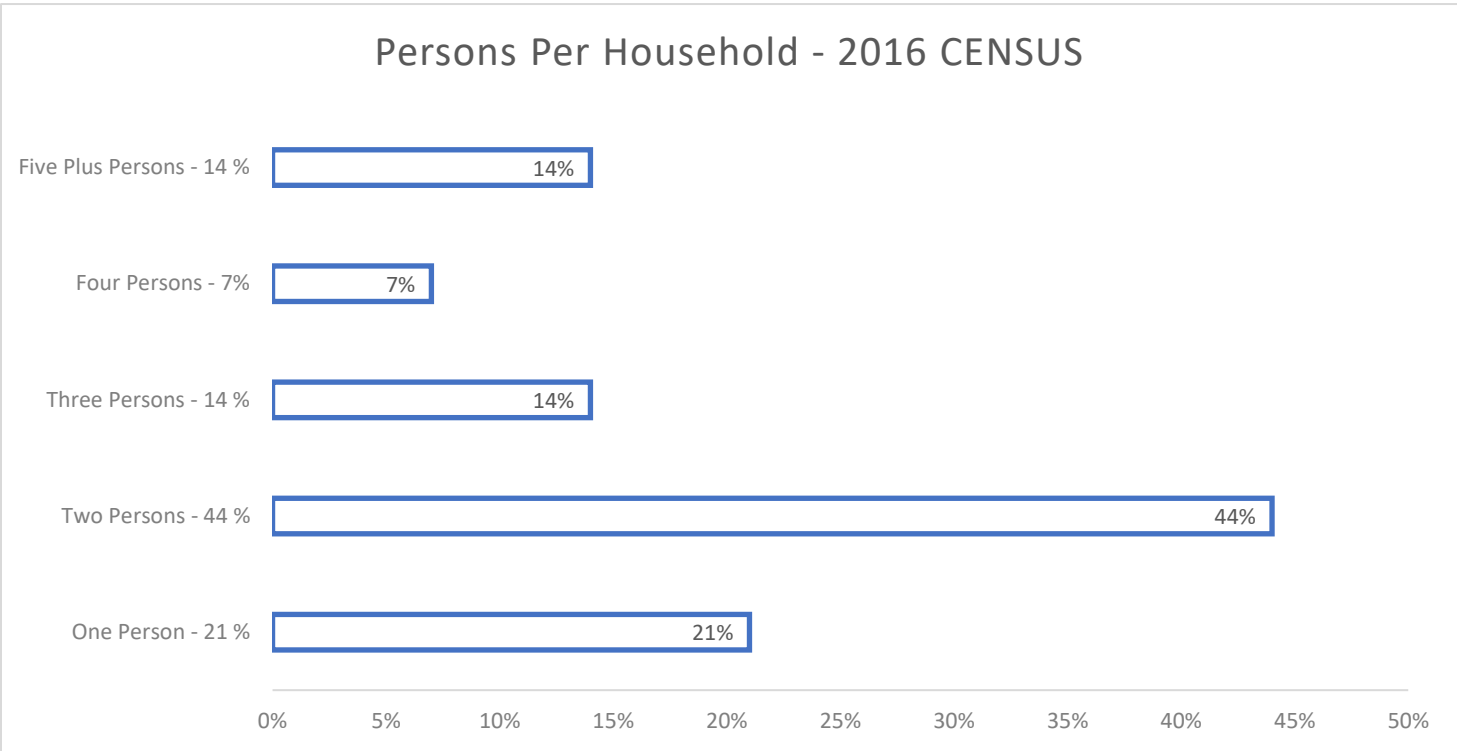

Education Profile

The educational profile for Bear Island’s population over 15 years of age is shown graphically in the below figure.

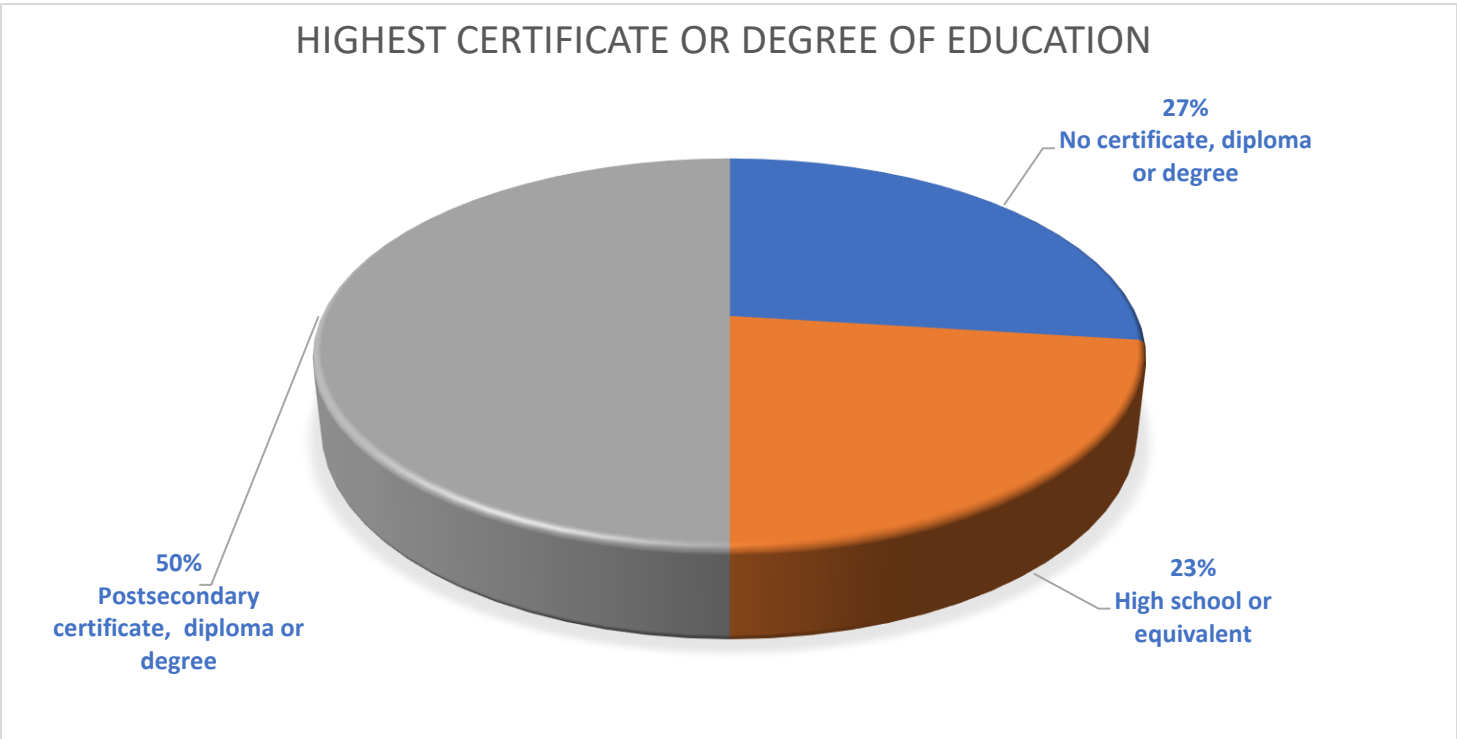

Capital Projects Underway

The Temagami First Nation Multi-Use Facility and Business Centre will include a community centre, job training facility and business centre, with adequate office space to accommodate current administrative/governance staff and any additional future anticipated staff, improving human resource efficiency with less crowded office space.

It will incorporate a new Community Hall, which will accommodate community functions with capacity of up to three-hundred (300) participants. The new Community Hall will be a large meeting space that will be rented out to other organizations.

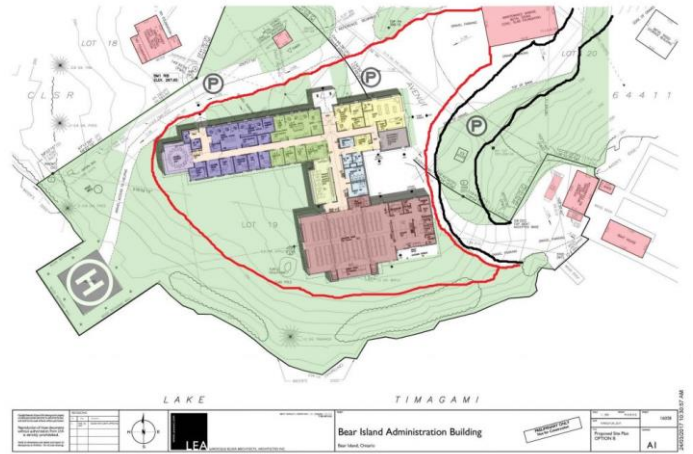

Directory

Band Office	705-237-8943
Doreen Potts Health Centre	705-237-8900
Family Healing and Wellness	705-237-8900
Home and Community Care	705-237-8275
Lands and Resources	705-237-8600
Economic Development	705-237-8600
Bear Island Education Authority	705-237-8982
Laura McKenzie Learning Centre	705-237-8982
Tillie Missabie Family Centre	705-237-8698
Public Library	705-237-8005
Justice Services	705-237-8636
Canoe House	705-237-8436
Warehouse	705-237-8501
Fire	1-866-762-0911
Shuttle/Ferry Contact Band Office	705-237-8943